

# Tact Switches waterproof

## Specifications:

Contact rating:	50 V DC max., 20 mA max.; 0.5 W max.
Contact resistance:	< 100 mΩ
Insulation resistance:	> 1000 MΩ at 100 V DC
Dielectric strength:	250 V, 50 Hz for the duration of 1 minute
Operating temperature:	-40 °C to +85 °C
Mechanical life:	minimum 1 000 000 operations
Contacts:	gold-plated over nickel barrier
Travel:	0.45 ±0.25 mm
Operating force:	4.5 ±1.0 N
Terminals:	brass, tin-plated
Material:	case: thermoplastic UL 94 V-0), black, TMP 1-1: blue button: silicon rubber, black;
Protection:	IP 67
Mounting:	on pc-board
Soldering conditions:	wave-soldering – max.: 5 sec, 270 °C

5

washable

## Models: Switching functions

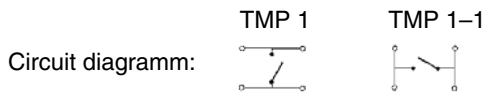
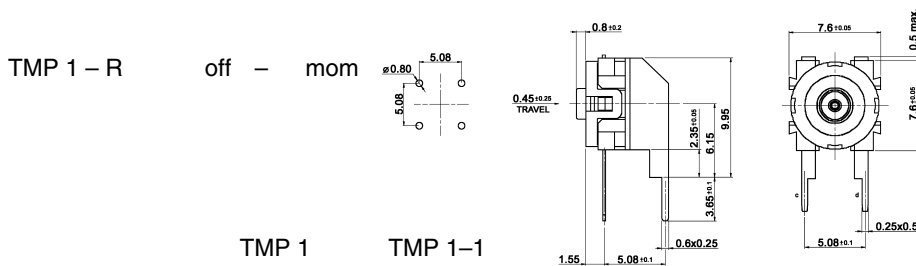
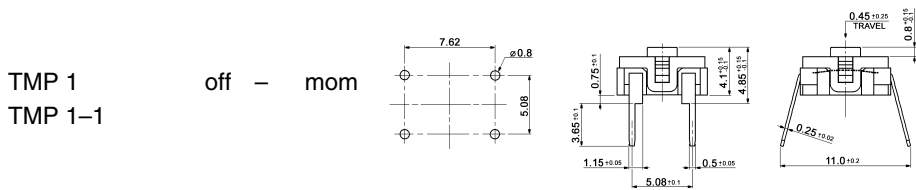

## Accessories and mounting dimensions:

Caps

light grey KTT 107

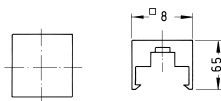

dark grey KTT 217  
light grey KTT 227  
red KTT 209

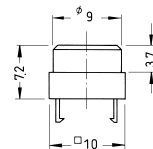

(More colours in request, MOQ 25 K)

